

PFX-3156

Gooseneck LED Light



DESCRIPTION

PFX-3156 Gooseneck Light is a unique decorative lighting fixture that allows you to update the look of your building. Elegant and curved goose neck arm, simple and low-key appearance design, can be well applied to a variety of architectural styles. Quick and easy Installation. Fixture offer 5 CCT adjustability. Actual performance may differ as a result of end-user environment and application. All values are design or typical values, measure under laboratory conditions at 25°C(±5°C) specifications subject to change without notice.



FEATURES

Construction

- Durable surface coating powder spraying can extends the durability of the fixture
- The integrated shell design can make good use of a variety of wet location environments.

Optical System

- General distribution type for most environments.
- Scalable Lumen Packages from 1000 to 3000 Lumens.
- The use of advanced refraction and reflection optical design concepts provides an optimal combination of vertical and horizontal illumination.

LED Module

- the 28W offers Selectable CCTs, can be adjusted to be 2700K/3000K/ 4000K/5000K/6500K.

Electrical

- Universal Voltage 120-277VAC for the 28W model.
- 28W supports the standard 0-10V dimming driver configuration
- Power factor >90%, THD <20%
- Operating Temperature Range: -40°C to 40°C (-40°F - + 104°F).

Control

- Integrated Photocell included.

Installation and Mounting

- Wall mount.

Lifespan

- Estimated 50,000-hour LED lifespan based on IES LM-80 results and TM-21 calculations.

Warranty

- Five-year limited warranty

Certifications

- UL cUL wet location pending.

Disclaimer:

Due to the rapid pace of technology change in the Lighting industry, the Information and Data presented in this spec sheet is for reference purposes only, please confirm with PARAFLEX at the time of finalizing the order or design. PARAFLEX does not warrant or represent that the information is free from errors or omission. The information may change without notice and PARAFLEX is not in any way liable for the accuracy of any information printed and stored or in any way interpreted or used.

PFX-3156
Gooseneck LED Light



PERFORMANCE

Model NO	Power Factor	Wattage	Voltage/Current Input		Light Efficiency	CCT Selectable
			120V	277V		
PFX-3156	>0.9	28W	0.23A	0.1A	110LM/W	2700K/3000K/4000K/5000K/6500K

PERFORMANCE DATA

Specification/Model	PFX-315628W27VDDKDPAD
LED Driver	UL Driver
Input power	28W
Lumen output	3080LM
Efficiency	110LM/W
CRI	>80
Color Temperature	2700K/3000K/4000K/5000K/6500K
Input voltage	120-277V/AC
Light distribution type	120D
Working temperature	-20+45°C
Junction temperature	<75°C
Lamp efficiency	≥90%
Certificate	UL CUL DLC
Equivalent	40-120W MH/HPS

DIMENSION

unit: mm/inch

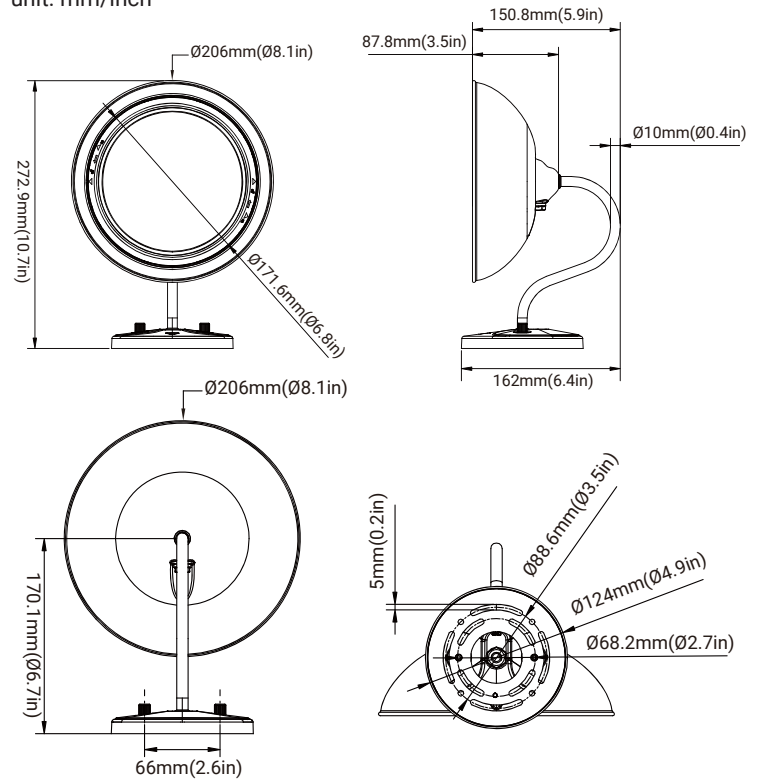

Disclaimer:

Due to the rapid pace of technology change in the Lighting industry, the Information and Data presented in this spec sheet is for reference purposes only, please confirm with PARAFLEX at the time of finalizing the order or design. PARAFLEX does not warrant or represent that the information is free from errors or omission. The information may change without notice and PARAFLEX is not in any way liable for the accuracy of any information printed and stored or in any way interpreted or used.

PFX-3156

Gooseneck LED Light



Special Function

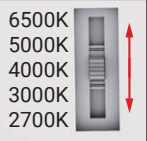
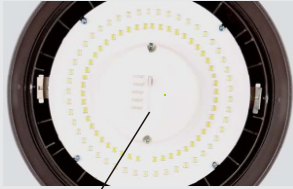

CCT SELECTABLE

28W model has the function of field configurable CCTs.

CCT SELECT



Five CCTs adjustable (2700K, 3000K, 4000K, 5000K, 6500K)

PRODUCT ORDERING GUIDE

PFX-315628W27VDDKDPA

D 1 3 4

PFX-3156 28W 27V DDKDPA
D

PFX-3156 Company name

28W Power28 W

27V 120-277VAC

DISTRIBUTION DIAGRAM

PFX-315628W27VDDKDPAD

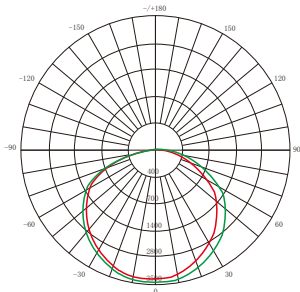

AVERAGE BEAM ANGLE(50%): 118.3°

UNIT:CD

— C0/180,113.

— C30/270,100.1

— C60/240,108.6

— C90/270,130.9

Lumens:3080LM

Test Number:28W

Test Number:5000K

INSTALLATION INSTRUCTION

WARNING

- To avoid electric shock, disconnect power at source prior to installation.
- The installation should be performed by qualified electricians or lighting technicians.
- Before conducting any installation, maintenance, or removal, disable all power to the luminaries and wait until the fixture cool down.
- Do not touch the fixture while it is in service.
- Operating temperature is -40°C to 40°C
- If there is any problem with the fixture, DO turn off power and DO NOT attempt repair unless you are a qualified technician or the customer service member.

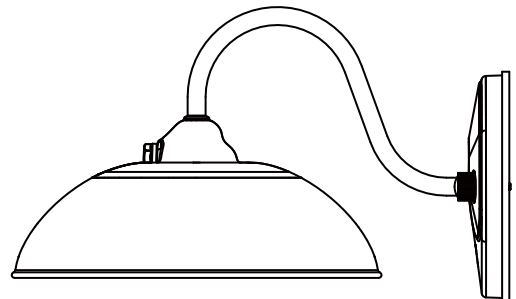

Disclaimer:

Due to the rapid pace of technology change in the Lighting industry, the Information and Data presented in this spec sheet is for reference purposes only, please confirm with PARAFLEX at the time of finalizing the order or design. PARAFLEX does not warrant or represent that the information is free from errors or omission. The information may change without notice and PARAFLEX is not in any way liable for the accuracy of any information printed and stored or in any way interpreted or used.

PFX-3156

Gooseneck LED Light



INSTALLATION INSTRUCTIONS

1. Attach the gasket on the back of the mounting bracket for a weather tight sea, and then secure the bracket to the junction box with 8-32x1/2' screws.
2. Connect the wires correctly (reference wiring diagram). Carefully tuck all wiring back into the junction box, and then secure the fixture to the mounting bracket with 2pcs 4*20 screws.

Note: Make sure that a wires are securely connected and that there are no exposed conductors and a wires do not get pinched

3. To ensure waterproof seal, apply weatherproof silicone sealant (supplied by others) around the edge of the wall mounting box and /or junction box. **Note:** Failure to properly caulk the mounting box and or junction box bonding surface may result in water damage, which is not covered by the warranty.

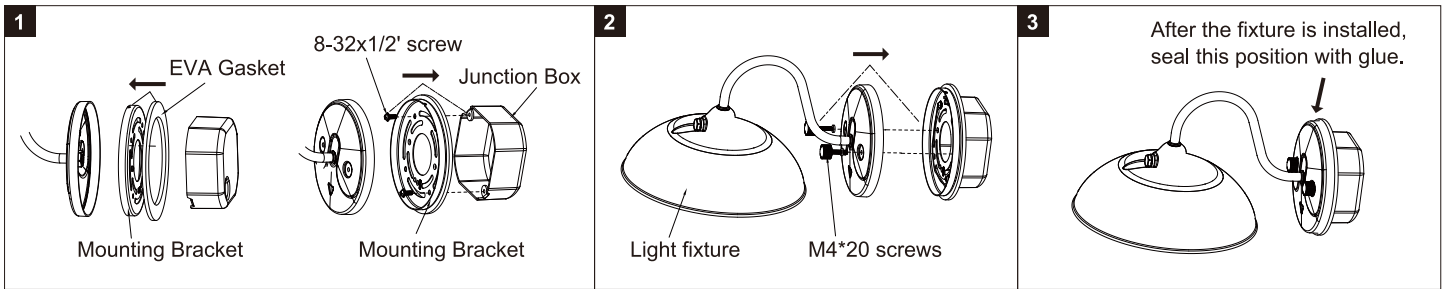

COLOR TEMPERATURE ADJUSTMENT (optional)

1. With power disconnected, twist the translucent shield counterclockwise and turn the color temperature dip switch to the desired color temperature.
 2. After adjusting the color temperature, twist the translucent shield clockwise to the closed state
- Note:** The color temperature adjustment must be operated with the power disconnected.
The operation is shown in the following diagram.

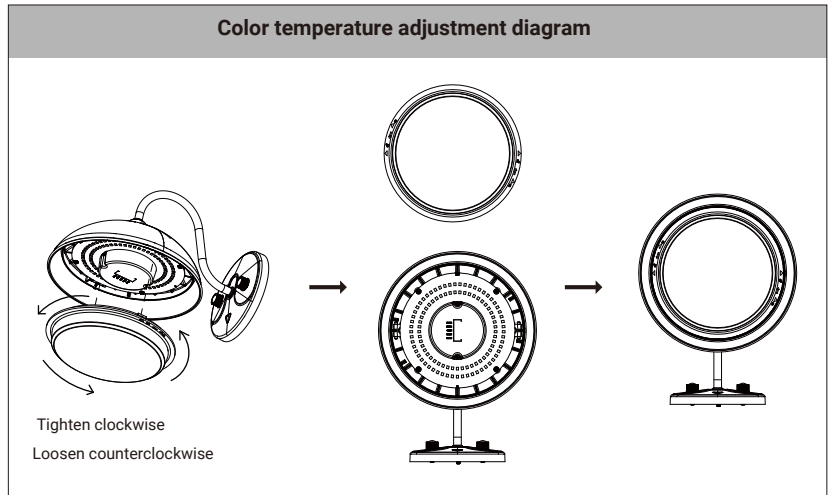
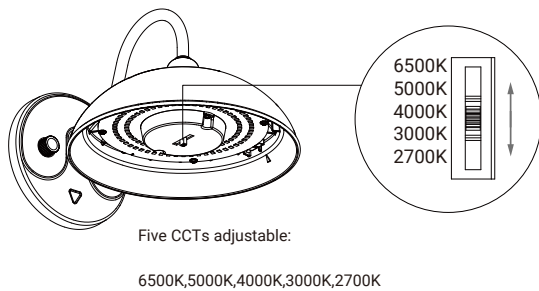

PARTS LIST

Mounting Bracket (1pc)	EVA Gasket (1pc)	M4*20 screw (2pcs)	8-32x1/2' screw(2pcs)

Disclaimer:

Due to the rapid pace of technology change in the Lighting industry, the Information and Data presented in this spec sheet is for reference purposes only, please confirm with PARAFLEX at the time of finalizing the order or design. PARAFLEX does not warrant or represent that the information is free from errors or omission. The information may change without notice and PARAFLEX is not in any way liable for the accuracy of any information printed and stored or in any way interpreted or used.