

## Installation Instruction

### Warning :

1. Can not use the electric generator to test the LED lamp.
2. This luminaire must be installed in accordance with your local electrical codes and requirements.
3. Do not install the luminaire in the rain, to avoid lightning stroke and damage to luminaire.

### Installation notice :

1. This luminaire must be installed by qualified electrician to avoid electric shock and fire accident;
2. Wear gloves before installation in order to avoid injury;
3. Turn off the power immediately when there is smoke and fire during installation; inform professionals to overhaul;
4. This luminaire is suited for outdoor use.

The installation of the product can be used when it is marked with "V".

### Installation I:

#### Wiring from the bottom of luminaire

1. Cut holes on the wall according to locating plate.  
(Figure 1-1)

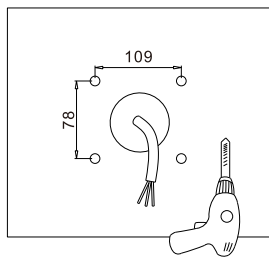

Figure 1-1

2. Fix rubber plugs into holes. (Figure 1-2)

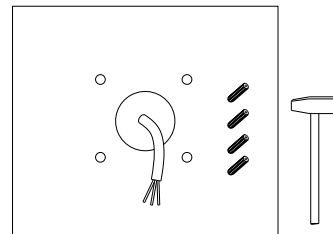

Figure 1-2

3. Align mounting bracket with hole; tighten screws.  
(Figure 1-3)

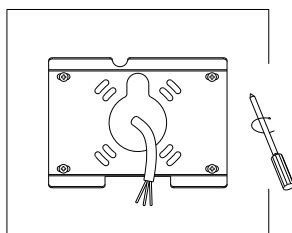

Figure 1-3

4. Make wiring connection and go through isolation treatment. (Figure 1-4)

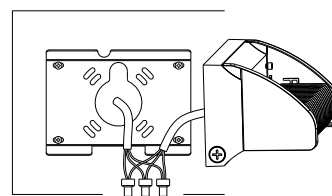

Figure 1-4

5. Fix the luminaire on the bracket and tighten screws on the bottom (Figure 1-5)

6. After installation, tighten the screws. (Figure 1-6)

# PFX-3131

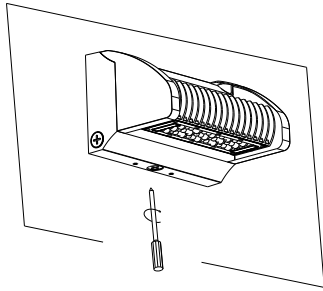

Figure 1-5

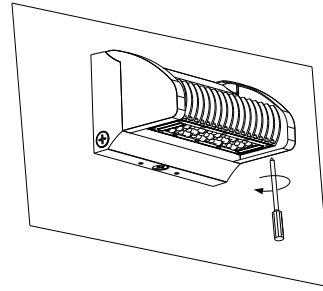

Figure 1-6

## Installation II : Wiring from the bottom of luminaire

1. Cut holes on the wall according to locating plate .  
(Figure 2-1)

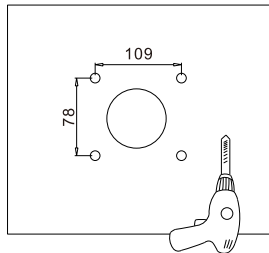

Figure 2-1

2. Fix rubber plugs into holes.(Figure 2-2)

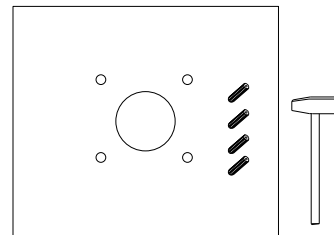

Figure 2-2

3. Align mounting bracket with hole; tighten  
screws. (Figure 2-3)

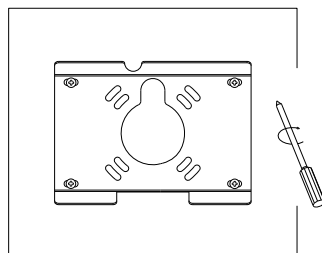

Figure 2-3

4. Fix the luminaire on the bracket; makewiring  
connection from side and go through isolation  
treatment.(Figure 2-4)

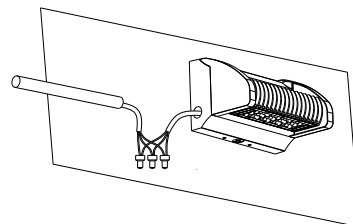

Figure 2-4

5. Tighten the pipe on the luminaire; after installation. tighten  
the screws.(Figure 2-5)

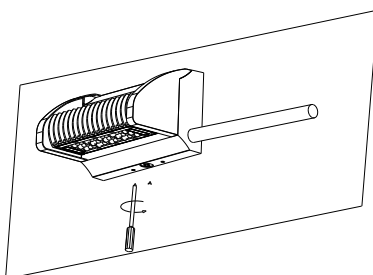

Figure 2-5

# PFX-3131

□ **Installation II :**  
**Bracket installation**

1. Cut holes on the wall according to locating plate.(Figure 3-1)

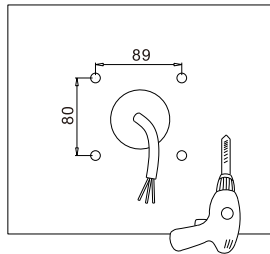

Figure 3-1

2. Fix rubber plugs into holes.(Figure 3-2)

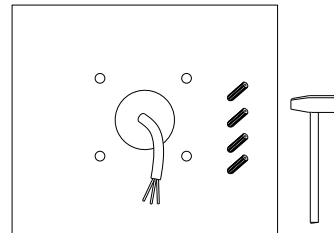

Figure 3-2

3. Align mounting bracket with hole; tighten screws.(Figure 3-3)

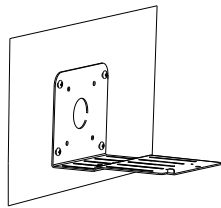

Figure 3-3

4. Pass wires through rubber ring and junction box, align with holes and lock junction box.(Figure 15)

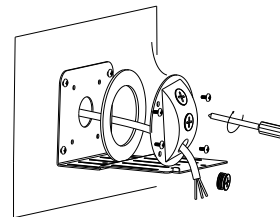

Figure 3-4

5. Make wiring connection and go through isolation treatment.(Figure 3-5)

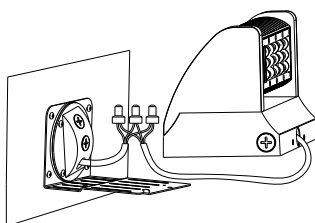

Figure 3-5

6. Push the wires into the junction box; after installation, tighten the screws. (Figure 3-6)

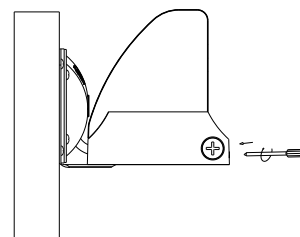

Figure 3-6