

ZSL

FLEXIBLE LED POST TOP LUMINAIRE



PROJECT

DATE

TYPE

NOTES

REV: 18 0728



HEAVY-DUTY, IP-66 RATED HOUSING

The ZSL is constructed with Die Cast Aluminum End-Caps and Individually sealed LED Modules to create a Heavy-Duty Housing

FLEXIBLE LIGHT OUTPUT CONFIGURATIONS

Extensive offering of Wattage, Optics and CCT options allow the ZSL to meet a wide-range of project requirements

EASY TO INSTALL MOUNTING HARDWARE

The ZSL comes standard with an Integral Slip Fitter engineered to be installed on a 2.375" Diameter Pole

120-277V STANDARD

PRODUCT APPLICATIONS

- Parking Lots
- Walkways
- Streetscapes
- Plazas
- Playgrounds
- Parks & Recreational Fields

When Specifying Options, Please Check with Factory for Availability and Lead-Time.

ORDERING GUIDE

Sample Part # ZSL - 100W - 40K - BZ - PC1 - D1

MODEL	WATTAGE	COLOR TEMPERATURE (CCT)	OPTICS	HOUSING COLOR	OPTIONS & ACCESSORIES
ZSL	60W	30K 3000K - WARM WHITE	T1 TYPE I	BZ BRONZE (STANDARD)	PC1 120V PHOTOCELL
	100W	40K 4000K - NEUTRAL WHITE	T2 TYPE II	WH WHITE	PC2 208/277V PHOTOCELL
	120W	50K 5000K - COOL WHITE	T3 TYPE III	BL BLACK	MS MOTION SENSOR
	150W	57K 5700K - DAYLIGHT	T4 TYPE IV	SL SILVER	D1 0-10V DIMMING
	200W		20D TYPE V - 20° BEAM ANGLE		D2 STEP DIMMING
	250W		40D TYPE V - 40° BEAM ANGLE		NC1 NETWORK CONTROLS FOR ZIGBEE
	300W		80D TYPE V - 80° BEAM ANGLE		HS HOUSE-SIDE SHIELD
			170D TYPE V - 170° BEAM ANGLE		WG PROTECTIVE WIRE GUARD
					EM EMERGENCY DRIVER
					V1* 480/347V INPUT (120-277V STANDARD)
					*NOT AVAILABLE WITH A PHOTOCELL OR MOTION SENSOR

PRODUCT SPECIFICATIONS

WATTAGE	DELIVERED LUMENS	EFFICACY	MODULES	X: WIDTH
60W	7,380 LM	123 LM/W	2	10.7"
100W	12,300 LM	123 LM/W	3	13.5"
120W	14,760 LM	123 LM/W	4	16.3"
150W	28,450 LM	123 LM/W	5	19.1"
200W	24,600 LM	123 LM/W	6	21.9"
250W	30,750 LM	123 LM/W	7	24.7"
300W	36,900 LM	123 LM/W	8	27.5"

Notes
Specifications Determined at 5000K and 80° Beam Angle

PRODUCT DIMENSIONS

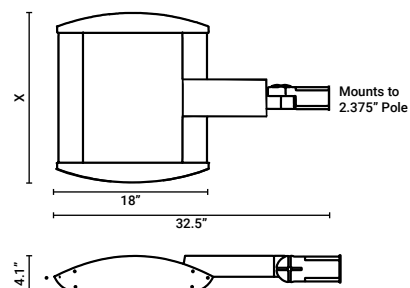

HOUSING CONSTRUCTION

Body is comprised of heavy duty die cast end caps with extruded aluminum sides connecting them. As the fixture increases in wattage, the extruded portions become longer to accommodate additional LED modules. The driver is housed inside one of the end caps. Since the LED modules and driver are all individually sealed, the entire fixture is vented to improve thermal dissipation. A 6' 18/3 power supply cord is standard on all models.

LED MODULES

The LED modules are individually IP-66 sealed, with each board mounted directly to a heat-sink and lens

LENS CONSTRUCTION

The lens is made of molded acrylic and also acts as the primary optic for the fixture

DIMENSIONS

Fixed size for the end caps, variable size depending on wattage (number of modules) for the extruded sides

FINISH

Exterior rated powder coat. Available in standard Bronze, Silver, White, Black, or in a Custom Color

WARRANTY

Standard 5-Year Warranty

LEDS

Nichia High-Power LEDs

DRIVER

Meanwell HLG Series Driver mounted with screws onto a raised rib casting within the luminaire's end-caps; Contact factory for specifications.

EM DRIVER

Optional EM Driver mounted with screws onto a raised rib casting within the luminaire's end-caps. Optional EM provides 45W of output to produce 5400 lumens for a minimum of 90 minutes. Contact factory for questions or alternate EM performance/output options.

VOLTAGE

120-277V Input Standard, 347V/480V Input Available. THD <20% Power Factor >90%

DIMMING

0-10V and Step Dimming is available as an option. Step dimming is standard 50%

CONTROLS

Zigbee Connectivity is Available as an Option

OPERATING TEMPERATURE

-20C to 40C. Cold Weather Operation Available, Consult Factory

LUMEN MAINTENANCE

L70 Rating of over 150,000 Hours up to 40C

PHOTOMETRICS / AXIAL DIAGRAMS: 60W - 40K

V: Front View - H: Side View

FOR ADDITIONAL INFORMATION PLEASE DOWNLOAD IES FILES FROM WEBSITE

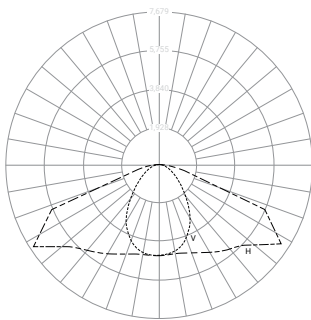

T1
IES TYPE I DISTRIBUTION

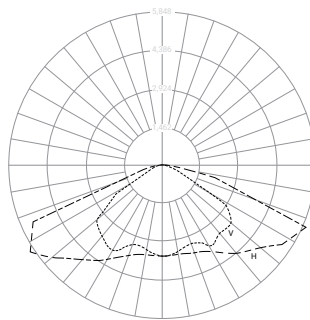

T2
IES TYPE II DISTRIBUTION

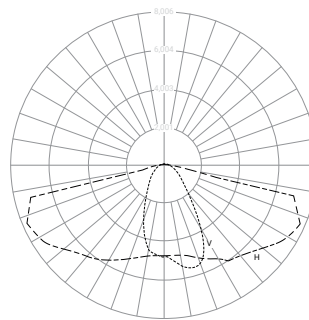

T3
IES TYPE III DISTRIBUTION

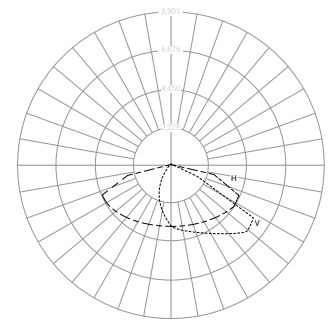

T4
IES TYPE IV DISTRIBUTION

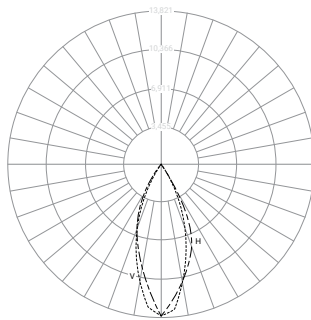

40D
IES TYPE V DISTRIBUTION - 40° BEAM ANGLE

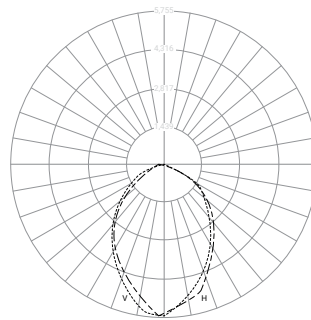

80D
IES TYPE V DISTRIBUTION - 80° BEAM ANGLE

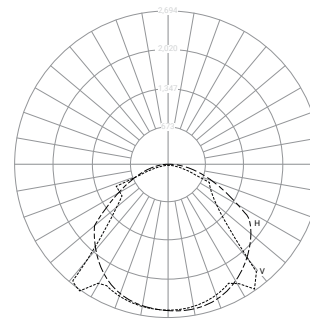

170D
IES TYPE V DISTRIBUTION - 170° BEAM ANGLE